

S6244

2008-2010 FORD F250/F350/F450, EC/CC
6.4L POWERSTROKE, FILTER BACK, 4.0"
DUAL SPLIT SIDE

MBRP®

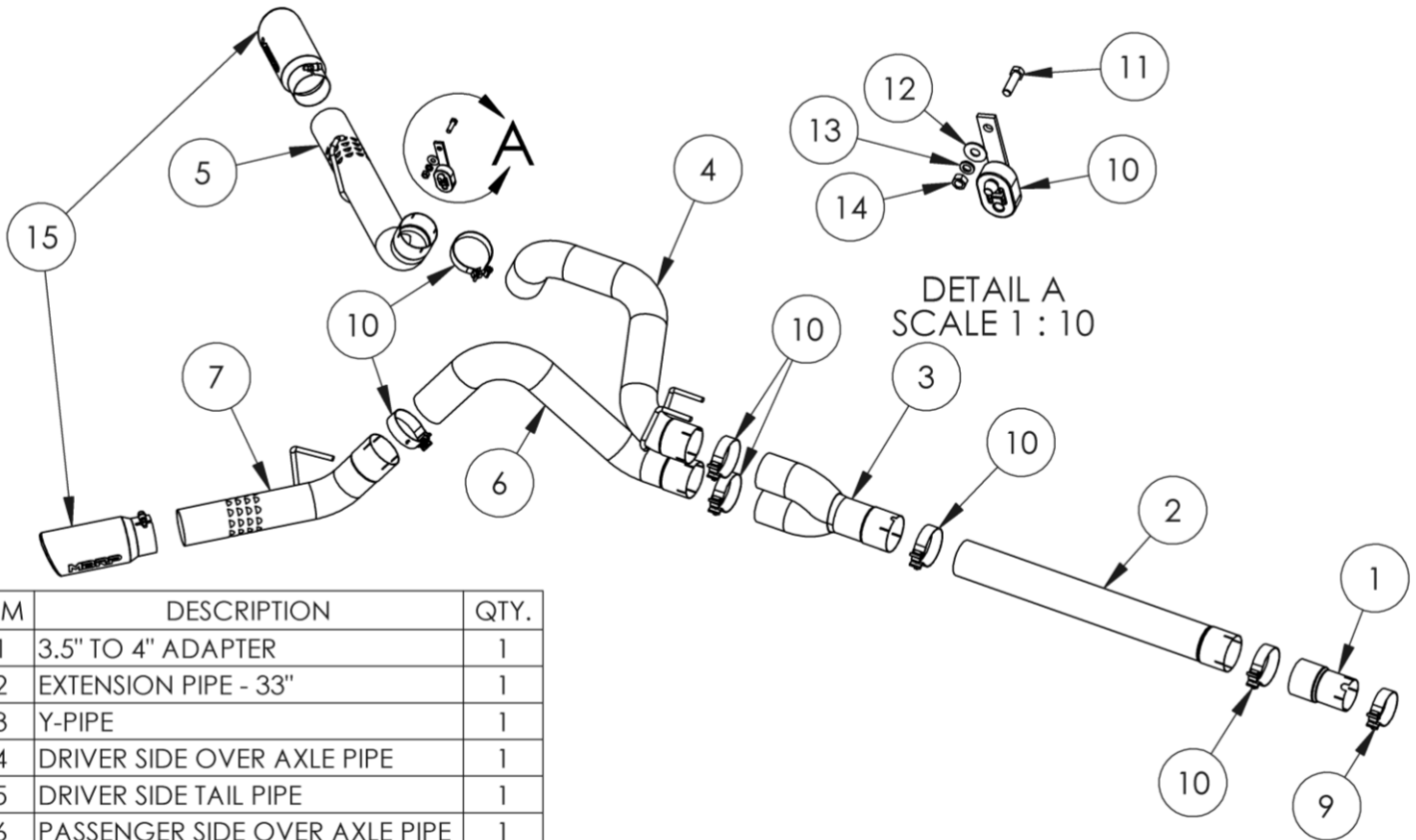

DETAIL A
SCALE 1 : 10

ITEM	DESCRIPTION	QTY.
1	3.5" TO 4" ADAPTER	1
2	EXTENSION PIPE - 33"	1
3	Y-PIPE	1
4	DRIVER SIDE OVER AXLE PIPE	1
5	DRIVER SIDE TAIL PIPE	1
6	PASSENGER SIDE OVER AXLE PIPE	1
7	PASSENGER SIDE TAIL PIPE	1
8	HANGER ASSEMBLY	1
9	3.5" BAND CLAMP	1
10	4" BAND CLAMP	6
11	7/16" X 1 1/2" BOLT	1
12	7/16" FLAT WASHER	1
13	7/16" LOCK WASHER	1
14	7/16" NUT	1
15	EXHAUST TIP	2

PLEASE READ BEFORE STARTING INSTALLATION

While MBRP has made every effort to ensure that all components of this system are of superior quality and properly packaged, it is the installer's responsibility to ensure the following before removal of the factory exhaust:

- that ALL components shown above are present.
- that ALL mating components fit together.
- that there are no damaged components.
- that the system you have purchased is appropriate for your vehicle year, model and configuration.
- that the system will not interfere with any modifications previously installed or planned.
- that you have read and understand these instructions.

If you have any questions or are uncertain about any aspect of the installation of this system to your vehicle please contact your dealer before commencing installation.

Removal of Stock System:



Figure 1

1. Apply penetrating lubricant liberally to all exhaust fasteners, hangers and rubber insulators.
2. Loosen the nut on the band clamp located behind the particulate filter using a 15mm wrench or socket. **Refer to Figure 1.**
3. Remove the muffler and tail pipe from the OEM rubber hangers. Cut exhaust as shown in **Figure 2.** Remove from vehicle.

Installation of MBRP Performance Exhaust:



Figure 2

1. Install the **Adaptor** over the particulate filter using the **3.5" Clamp**. Leave the clamp loose until final alignment. **Refer to Figure 3.**
2. The **Extension Pipe** provided is pre-cut for the crew cab long bed configuration. Cut the **Extension Pipe** to length as required. **See Figure 5.** The **Extension Pipe** is not required on a super cab short box (6.5'). Slide a **4" Clamp** over the **Extension Pipe** and install onto the **Adaptor** installed in Step 1. The clamp should remain loose enough for adjustability. **Refer to Figure 4.**



Figure 3



Figure 4

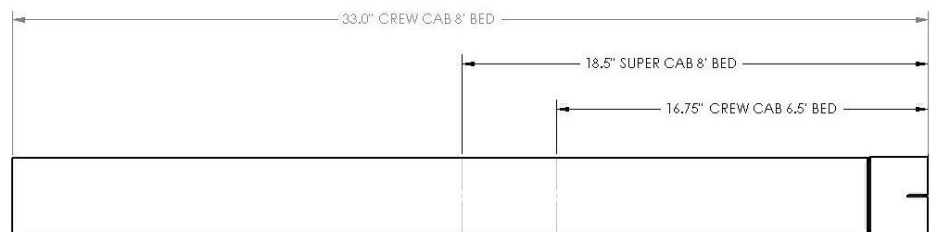

NOT REQUIRED ON SUPER CAB WITH 6.5' BED

Figure 5

3. Slide a **4" Clamp** onto **Y-Pipe**. Install the **Y-Pipe** over the **Extension Pipe**. Note: On the super cab 6.5' bed it would be installed to the **Adaptor**.

MBRP®



Figure 6



Figure 7



Figure 8

4. Slide a **4" Clamp** onto the lower outlet of the **Y-Pipe**. Install the **Passenger Side Over Axle Pipe** from the rear of the truck, over the axle and attach to the lower section of the **Y-Pipe**.
5. Slide a **4" Clamp** onto the **Passenger Side Tail Pipe** and install into the **Passenger Side Over Axle Pipe**.
6. Slide a **4" Clamp** onto the upper section of the **Y-Pipe**. Install the **Drivers Side Over Axle Pipe** from the rear of the truck, over the axle and attach to the upper section of the **Y-Pipe**. Install the **Driver Side Over Axle Pipe** into the OEM hangers, slide Clamps into position but don't tighten.
7. Install the **Hanger Kit** on the driver's side of the vehicle. **Refer to Figure 7**. Slide a **4" Clamp** onto the end **Driver Side Tail Pipe** then attach to the **Driver Side Over Axle Pipe**. **Refer to Figure 8**.
8. Install and adjust **Exhaust Tips** to suit.
9. Align the edge of band clamp with the edge of the joint it is connecting. Tighten all hardware and clamps, starting at the front and working rearward to secure the system. Check along the full length of the exhaust system to ensure there is adequate clearance for fuel lines, vent lines, brake lines, frame, bodywork, suspension, and any wiring, etc. If there is any interference detected, relocate, or adjust to provide adequate clearance. Ensure all clamp connections are secure and components are unable to rotate or slide. Band clamps require approximately 45 lb-ft (60 N-m) of torque. Verify clearances, system security and band clamp torque after 30- 60 miles (50-100 km) of driving.



Congratulations! You are ready to begin experiencing the improved power, sound and driving excitement of your **MBRP** performance exhaust system. We are certain that you will enjoy your purchase.