

S5326

05-15 TOYOTA TACOMA, 4.0L,
EXTENDED/CREW CAB, CAT BACK, 2.5"
SINGLE SIDE, EXC. X-RUNNER

MBRP
INC.
PERFORMANCE EXHAUST

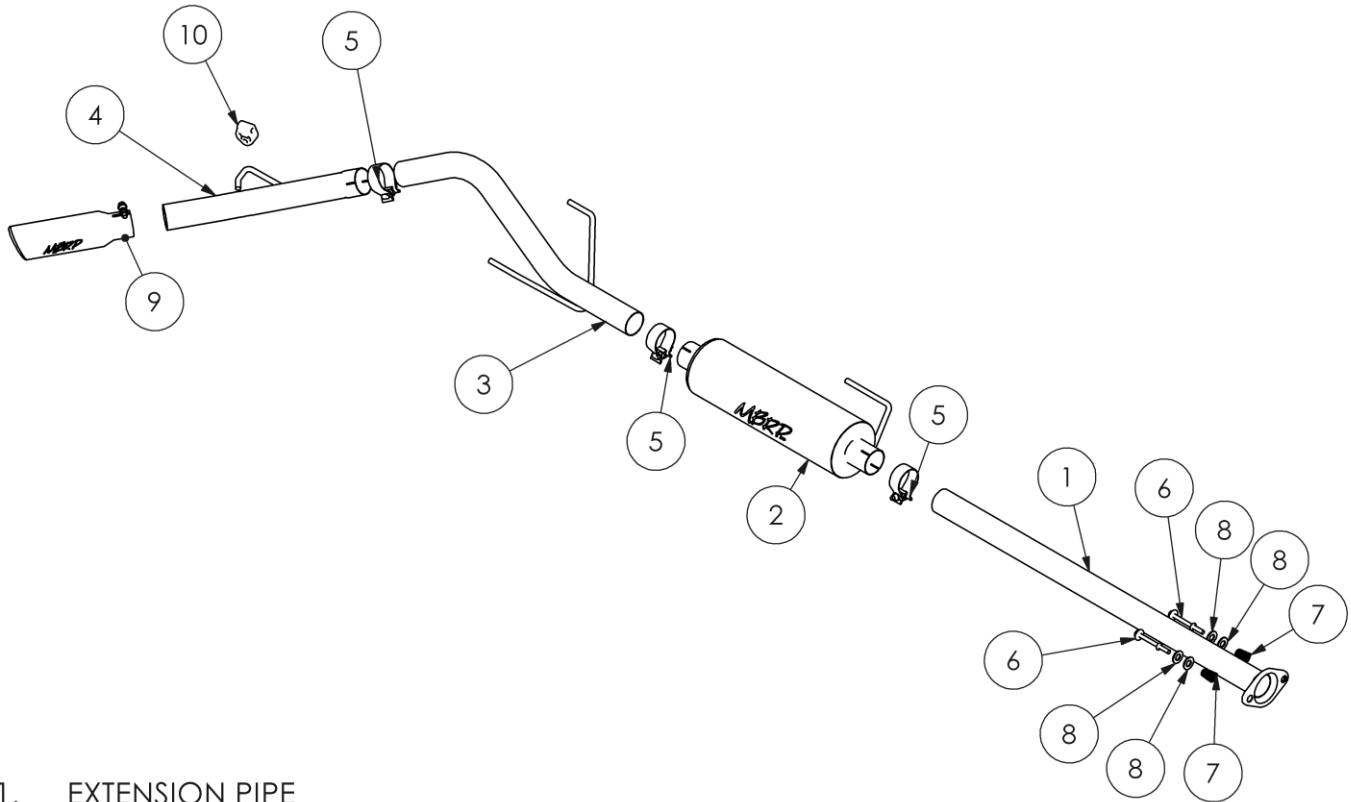

1. EXTENSION PIPE
2. MUFFLER
3. OVER AXLE PIPE
4. TAIL PIPE
5. 2 1/2" CLAMP(3PCS)
6. EXISTING BOLT (2PCS)
7. EXISTING SPRING(2PCS)
8. 5/8" FLATWASHER (4PCS)
9. EXHAUST TIP
10. 90° RUBBER INSULATOR

NOTE: SADDLE CLAMPS USED IN ALUMINIZED SYSTEMS

PLEASE READ BEFORE STARTING INSTALLATION

While MBRP Inc. has made every effort to ensure that all components of this system are of superior quality and properly packaged, it is the installer's responsibility to ensure the following before removal of the factory exhaust:

- that ALL components shown above are present.
- that ALL mating components fit together.
- that there are no damaged components.
- that the system you have purchased is appropriate for your vehicle year, model and configuration.
- that the system will not interfere with any modifications previously installed or planned.
- that you have read and understand these instructions.

If you have any questions or are uncertain about any aspect of the installation of this system to your vehicle please contact your dealer before commencing installation.

Removal of Stock System:



Figure 1

1. Apply a penetrating lubricant liberally to all exhaust fasteners, hangers and rubber insulators.

2. Remove the bolts and springs holding the front flange together and disconnect exhaust system. Do not discard this hardware as it is used for the installation. **Refer to Figure 1.**



Figure 2

3. Remove the hangers from the rubber insulators and remove the exhaust from the vehicle. If a hoist or hydraulic lift is not being used the tail pipe may need to be cut to clear the rear axle. **Refer to Figure 2.**

Installation of MBRP Inc. Performance Exhaust:



Figure 3

1. Slide two of the **5/8" Flatwashers** over the bolts previously removed from the flange and then slide the springs over the bolts. Now loosely attach the **Extension Pipe** to the flange using the fasteners.

Refer to Figure 3.

Note: The **Extension Pipe** will need to be trimmed on some models. Refer to the illustration below.

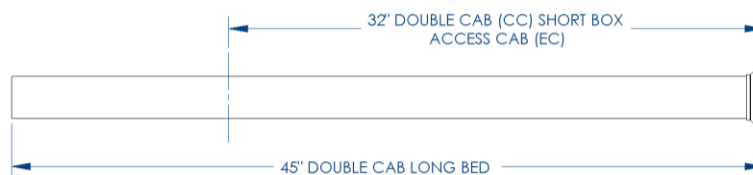

Figure 4

2. Install the **Muffler** onto **Extension Pipe** using one of the **2 1/2" Clamps**. Then install the hanger into the factory rubber insulator. Do not tighten the clamp at this time.

Refer to Figure 4.

3. Loosely install the **Over Axle Pipe** connecting it to the **Muffler** outlet with a **2 1/2" Clamp**. Install the hangers into the rubber insulator located above the **Over Axle Pipe**.

Refer to Figure 4.



Figure 5

4. Connect the expanded end of the **Tail Pipe** to the **Over Axle Pipe** with the remaining the **2 ½” Clamp**. Install the hanger into the factory rubber insulator. **Refer to Figure 5.**

NOTE: 2013 and newer models require the removal of the factory rubber insulator and the installation of the 90° Rubber Insulator to the outside frame mount.

Refer to Figure 6.



Figure 6

5. Install and adjust the **Exhaust Tip** to suit. Tighten the lock bolt located on the **Exhaust Tip**.

Refer to Figure 7.



Figure 7

6. Make sure that the exhaust is properly in place before tightening clamps. Start at the front of the exhaust system and begin tightening all connections.

7. Tighten all hardware and clamps, starting at the front and working rearward to secure the system. Check along the full length of the exhaust system to ensure there is adequate clearance for fuel lines, brake lines, frame, bodywork, suspension and any wiring, etc. If there is any interference detected, relocate or adjust to provide adequate clearance.



Congratulations! You are ready to begin experiencing the improved power, sound and driving excitement of your **MBRP Inc.** performance exhaust system. We know you will enjoy your purchase.