

# S5203

2020-UP FORD EXPLORER ST/PLATINUM,  
LINCOLN AVIATOR, 3.0L ECOBOOST,  
AXLE-BACK, 2.5" DUAL REAR, QUAD TIPS

# MBRP®

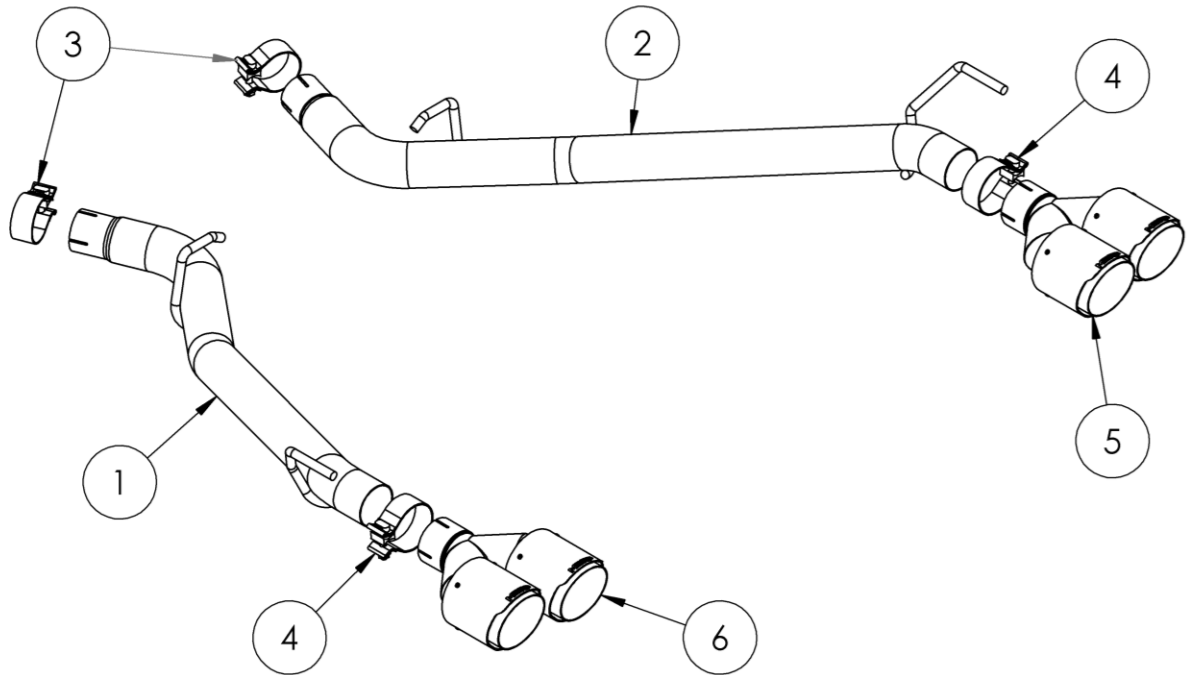

ITEM	DESCRIPTION	QTY
1	DRIVER-SIDE TAIL PIPE	1
2	PASSENGER-SIDE TAIL PIPE	1
3	2.17" CLAMP	2
4	2.5" CLAMP	2
5	PASSENGER-SIDE TIP	1
6	DRIVER-SIDE TIP	1

## PLEASE READ BEFORE STARTING INSTALLATION

While MBRP has made every effort to ensure that all components of this system are of superior quality and properly packaged, it is the installer's responsibility to ensure the following before removal of the factory exhaust:

- that ALL components shown above are present.
- that ALL mating components fit together.
- that there are no damaged components.
- that the system you have purchased is appropriate for your vehicle year, model and configuration.
- that the system will not interfere with any modifications previously installed or planned.
- that you have read and understand these instructions.

If you have any questions or are uncertain about any aspect of the installation of this system to your vehicle please contact your dealer before commencing installation.

# MBRP

## Removal of Stock System



**Figure 1**  
**Driver-Side**



**Figure 2**  
**Passenger-Side**

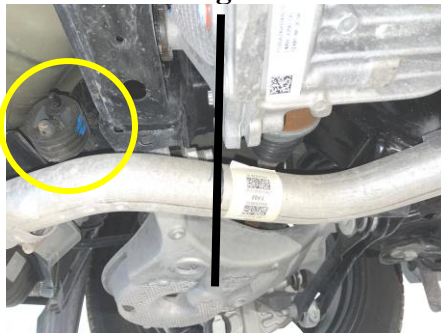

**Figure 3**



**Figure 4**

1. Mark the cut locations on the factory pipes approximately 2” towards the front of the vehicle from the rear crossmember. The cut locations align with the bottom edge of the differential cover, this can be used for reference.  
**Refer to Figures 1, 2, and 3.**

2. Cut the factory exhaust at the marked locations, perpendicular to the pipe.

3. Support the factory passenger-side muffler and remove the rubber isolator closest to the crossmember (middle isolator) from the exhaust. Lower the cut side of the muffler assembly and slide the muffler toward the front of the vehicle, out of the rear hanger, to remove it from the vehicle.  
**Refer to Figures 3 and 4.**

4. Repeat step 3 for the driver’s side.

## Installation of MBRP Performance Exhaust

1. Remove the middle isolators from the vehicle and install them into the hooked hangers of the **MBRP** tail pipes.  
**Refer to Figure 5.**

**Refer to Figure 5.**

2. Using the **2.17” Band Clamp**, install the **Passenger-Side Tail Pipe** into the rear isolator as far to the rear as possible. Then slide the **Passenger-side Tail Pipe** over the factory pipe. Install the middle isolator already on the **Passenger-Side Tail Pipe** back onto the vehicle. Do not tighten the clamp yet.  
**Refer to Figures 6 and 7.**

**Refer to Figures 6 and 7.**

3. Repeat step 3 for the **Driver-Side Tail Pipe**.

**Refer to Figure 8.**

# MBRP



**Figure 5**

4. Install the **Exhaust Tips** using the **2.5" Band Clamps** and align to your liking.  
**Refer to Figure 9.**



**Figure 6**

5. Align the edge of each band clamp with the edge of the joint it is connecting. Tighten all hardware and clamps, starting at the front and working rearward to secure the system. Check along the full length of the exhaust system to ensure there is adequate clearance for fuel lines, vent lines, brake lines, frame, bodywork, suspension, and any wiring, etc. If there is any interference detected, relocate, or adjust to provide adequate clearance. Ensure all clamp connections are secure and components are unable to rotate or slide. Band clamps require approximately 45 lb-ft (60 N-m) of torque. Verify clearances, system security and band clamp torque after 30-60 miles (50-100 km) of driving.



**Figure 7**



**Figure 8**

**Congratulations!** You are ready to begin experiencing the improved power, sound and driving excitement of your **MBRP** Performance Exhaust system. We know you will enjoy your purchase.

